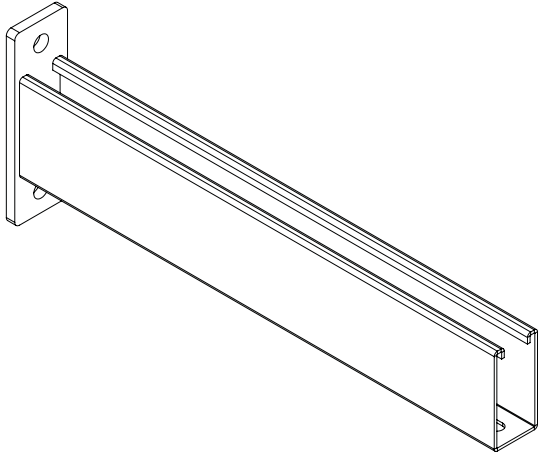

SP8 HORIZONTAL SUPPORT

Models (B):

400; 500; 600; 700; 800; 1000.

Material/Coating: HDG

Characteristics:

- Metallic
- Non-flame propagating component
- System with electrical continuity
- Electrically conductive component
- Minimum temperature of -50 °C
- Maximum temperature of 150 °C
- With metallic coating, resistance to corrosion:
HDG coating: class 6

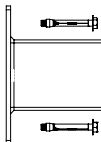
ASSEMBLING INSTRUCTIONS

- To fix the support to wall two anchors are needed.
- The tray installation for an electrical system should NOT run under other types of canalisations such as water, vapour or gas canalisations.
- To guarantee a good ventilation, we recommend installing the trays keeping a minimum distance of 250 mm between each tray.
- Trays which are placed on supports shall have to keep a gap of 20 mm from the wall to allow for a correct ventilation of the cables.
- To fix trays to support non-slip nuts are needed.

SAFE WORKING LOAD
